

PHOSPHATESMO KM

en

Test paper for the determination of acid phosphatase

(for detection of sperm spots in criminal investigations and juridicomedical cases)

Pack content:

Aluminium boxes holding 25 test papers 15 x 30 mm individually sealed in plastic tape.

Color reaction:

In the presence of acid phosphatase (spermatozoa), the test paper develops violet spots against a white background.

Method of application:

The carrier is normally subjected to a macroscopic examination for suspicious spots. Textiles generally assume boardlike consistency and yield a bluish, white or yellow fluorescence under a quartz lamp. PHOSPHATESMO KM offers the possibility to determine, on the spot, whether the traces found originate from spermatozoa. Take a small piece of the suspect material and soak for about one minute in water or physiological saline solution. Remove only as many test papers as are required, and reseal the container immediately after use. Expose the test paper by pulling apart the ends of the plastic tape. Do not touch the test paper zone. Place the moist test material on the test paper, which, after a few seconds, will show a clear, violet coloration in the presence of acid phosphatase.







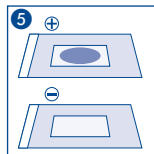
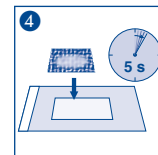
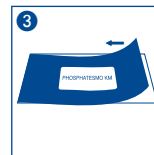
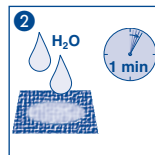
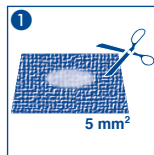

Specificity:

PHOSPHATESMO KM is specific for acid phosphatase. The reaction is not a suitable substitute for the microscopic determination of live spermatozoa.

Storage:

Avoid exposing the test papers to sunlight and moisture. Store the container below + 30 °C in a dry place.



 REF	Artikelnummer / Item number / Référence produit / Referencia / Artikelnummer / Numero di catalogo / Numer artykułu	 LOT	Chargencode / Batch identification / Numéro de lot / Código de lote / Productienummer / Codice del lotto / Numer partii
	Achtung! / Warning! / Attention! / ¡Atención! / Let op! / Attenzione! / Uwaga!		Verwendbar bis / Use by / À utiliser avant / Fecha de caducidad / Te gebruiken tot / Utilizzare entro (anno / mese) / Przydatność do użycia
	Temperaturbegrenzung / Permitted storage temperature range / Limites de température / Limites de temperatura / Temperatuurbegrenzing / Limite de tem- peratura / Ograniczenie temperatury		Trocken aufbewahren / Store in a dry place / Conserver au sec / Mantener seco / Op een droge plaats bewaren / Mantener asciutto / Przechowywać w suchym miejscu
	Gebrauchsanweisung beachten / Please read instructions for use / Respecter les instructions d'utilisation / Obsérvense las instrucciones de uso / Lees de bijsluiting / Consultare le istru- zioni per l'uso / Przestrzegać instrukcję użycia		Packung geschlossen halten / Keep container closed / Refermer la boîte / Mantenga el envase cerrado / Verpak- king gesloten houden / Conservare la confezione chiusa / Przechowywać pojemnik szczelnie zamknięty
	Ausreichend für <n> Prüfungen / Contains sufficient for <n> tests / Contenu suffisant pour <n> tests / Contenido suficiente para <n> tests / Voldoende voor <n> tests / Contenuto sufficiente per <n> test / Wystarczająco dla kontroli <n>		